



# SkyH2O Station™

*“Improving Communities Sustainability, Resiliency, Environment and Economy by Providing Fresh and Healthy Potable Premium Water at an Affordable Price”*



# Global Water Challenges



Water scarcity from droughts, overuse of aquifers is accentuated by failing infrastructure and growing populations



Municipalities struggling to provide adequate fresh-healthy drinking water to its residents. Anemia cases on the rise because of heavy metals in the drinking water.



The world needs to tackle water problem before it hinders the growth and livelihood of its inhabitants.



Polluted and toxic waters have created health and wellness concerns in its municipalities, specifically in places with heavy metals where the users of this water are suffering Anemia.



Water shortages are more common everyday and are creating tensions between countries, industries and the population.



Use of one-time-use plastics are severely impacting our environment and hurting the different ecosystems.

***“Municipalities across the globe face significant challenges to provide fresh drinking water to their residents. Current implemented “solutions” are further stressing a shrinking underground water source, while creating a huge one-time-plastic problem that threatens our planet and our own existence”.***





***“SkyH2O is introducing an environmentally responsible SOLUTION that provides businesses and residents with a high-quality and reliable water source: The SkyH2O Station™”.***

## **SkyH2O Station™**

- SkyH2O is implementing a **Project Based** global strategy that **uses the air to create water.**
- The solution is: **Scalable** and **Replicable** anywhere in the world with good atmospheric conditions.
- The SkyH2O Station™ is built upon our own technology: The **AWG Maximus 4.10 system.**
- Each site produces between 100,000 and 200,000Lts of water per day.
- We are at the initial stage of rolling-out of Phase I, 10 projects.
- These projects will provide premium drinking water at a most competitive price in each of their markets.
- They also provide local authorities and residents with water security during natural catastrophes.

# SkyH2O Station™ A Circular Business Model

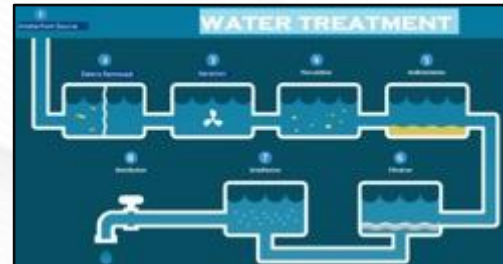
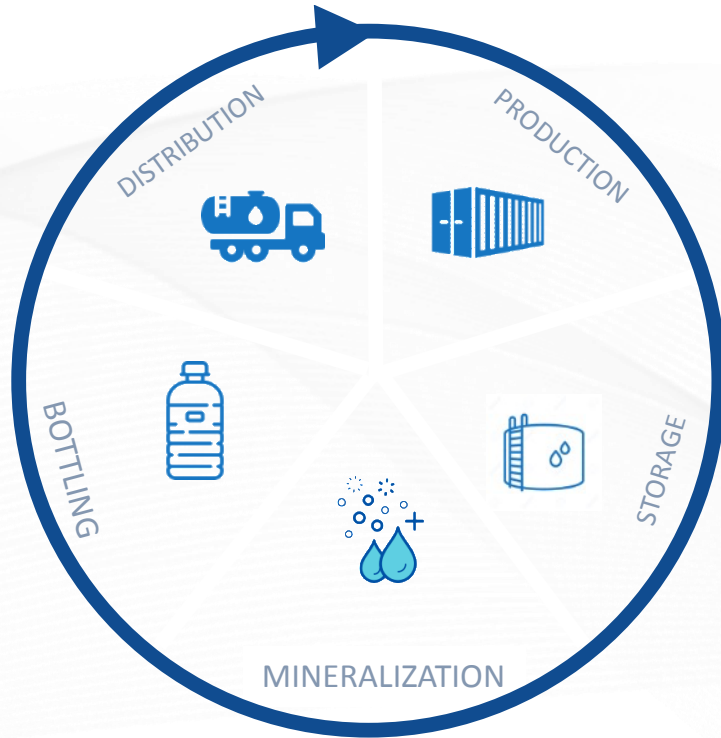

## GENERATION

- ✓ By World-leading atmospheric AWG technology: **The AWS MAXIMUS™ 4.10**
- ✓ Each machine generates **2,770GL or 10,500Lt /day** in locations with conditions of **80% RH and 27°C**.
- ✓ Each Station integrates over **12 units** to generate **+30,000GL or +115,000Lt /day**

## PREPARATION

- ✓ Advanced, proven and efficient water preparation methods.
- ✓ Exceeds standards of the **World Health Organization** ("WHO") and Local Water Authorities
- ✓ We provide the healthiest, potable water, improving the health and well being of consumers.

## BOTTLING & DISTRIBUTION

- ✓ Our facilities include advanced water bottling and cleaning.
- ✓ In-house produced environmentally responsible reusable and recyclable bottles that minimize the use of one-time plastics.
- ✓ Minimal carbo footprint by strategically locating SkyH2O Stations™ within a region.







# SKYH2O STATION™

## A Sustainable Water Security Solution

### SUMMARY (Per station)

- Production: **30,000Gal/115,000Lts** x day of drinkable water
- Investment: **US \$15.0M**
- Stabilized Annual Revenue: **\$11.0M**
- Annual Profit: **US \$3.0M (27%)**
- Jobs: **15 to 20** full-time “green jobs”
- Sales Price: **US \$1.00/Gl** or **MXP \$5.00/Lt.**
- Reach: **30,000 people** daily needs
- Useful Life: **+30 years**
- Value Proposition:
  - ✓ **Most competitively priced high-quality drinking water** available in the market.
  - ✓ Most resilient water solution providing **water security** in times of disaster.
  - ✓ Renewable **NetZero** Water resource from AWG.

# SkyH2O Station™ Sample Facility Layout



Min. Land Size:  
2.5 Acres/ 10,000sqm



## Project Partners





## Water Production at SkyH2O Stations™ Rely on our **AWG Maximus™ 4.10 Unit**



Rated Water Production:	10.500-lts or 2,779-gal x day
Atmospheric Nominal Conditions:	27°C y 80% RH
Electric Supply, full load:	132kW 400 V 50Hz, 3 phase 480 V 60Hz
Energy Consumption:	0.29/KWh/liter
Noise:	70 Decibels x unit
Size:	2.19m x 2.54m x 11.30m
Weight:	11,200 Kg
Operative Range:	From 5° to 50°C & from 25% RH





# SKYH2O STATION™

## A Sustainable Water Security Solution

### ENVIRONMENTAL BENEFITS

- Generates fresh water “from air” not exploiting aquifers or coastal desalinization.
- Does not further stress ground water supply (already at historic low levels)
- Avoids toxicity of forever chemicals, salt water and metals.
- Water is generated, processed, mineralized and bottled at the point of distribution.
- Avoids long-distance transportation costs and it’s carbon footprint.
- Eliminates use of decrepit and vulnerable water infrastructure.
- Bottling is made from advanced reusable, 100% degradable and recyclable next generation containers.
- Eliminates “tons” annually of one-time-use plastics for every project
- Reduces carbon footprint:
  - ✓ Use of electric water trucks.
  - ✓ Strategically located within urban areas.
  - ✓ Minimizes costly and polluting transportation.





# SkyH2O Stations Growth Path:

	<u>Phase I:</u> Regional	<u>Phase II:</u> America	<u>Phase III:</u> International
Year:	2021-22	2023-24	2024-27
Number of Stations:	10	30	100
Locations of Projects:	Texas and Baja California Sur	Texas, Florida, Louisiana, California, Baja California Sur	USA, Europe (Spain, Italy), MENA (UAE, KSA, Morocco), and Caribbean
Investment Value:	\$150.0M	\$450.0M	\$1.50B
Annual Revenue (cumulative):	\$110.0M	\$440.0M	\$1.54B
Annual Profits (cumulative):	\$30.0M	\$120.0M	\$420.0M

*In 2022 we start the “roll-out” of successful SkyH2O STATION™ in strategic locations in Texas and Baja California Sur to then expanding to across U.S.A. and from there to the World.*



# SkyH2O Station™



SkyH2O Headquarters



AWG Maximus™ Manufacturing



SkyH2O Water Station™



## Projected Phase I Rollout: North America - Regional

2021-2022



TEXAS

1. Angleton [NTP Q3 2022, COD Q4 2023]
2. Dickinson [NTP Q3 2022, Q4 2023]
3. Corpus Christi
4. Woodlands
5. San Antonio
6. Mont Belvieu
7. Brownsville
8. Victoria
9. Katy
10. Laredo



BAJA CALIFORNIA SUR

11. Cabo San Lucas
12. San Jose del Cabo
13. La Paz

10 Stations

2 countries

2 states

13 municipalities

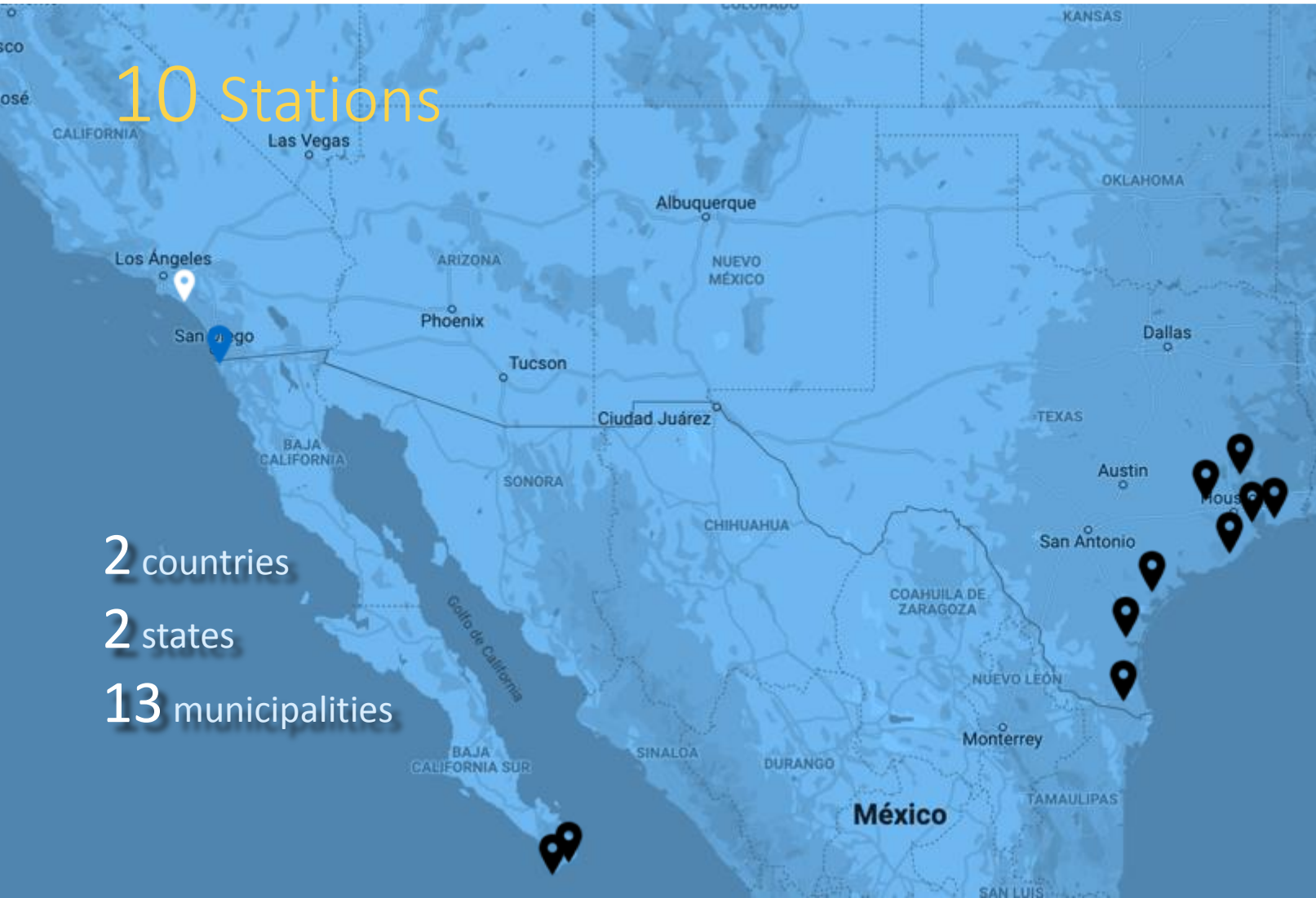



# SkyH2O Station™



SkyH2O Headquarters



AWG Maximus™ Manufacturing



SkyH2O Water Station™



## Projected Phase II Rollout: North America - National

2023-2024

30 Stations

2 countries  
5 states  
30 municipalities

Successful **SkyH2O Station™** locations require:



Good atmospheric conditions.



A reasonably low cost of energy.



Water stressed areas which drives up the value of drinking water.



Access to high-profile highway sites at reasonable prices.





Municipalities of more than 10,000 population.



Crossroads to service +100,000 consumers within about 10 miles or 16 kms.

# SkyH2O Station™

-  SkyH2O Headquarters
-  AWG Maximus™ Manufacturing
-  SkyH2O Water Station™



## Projected Phase III Rollout: International

2025-2027

100 Stations

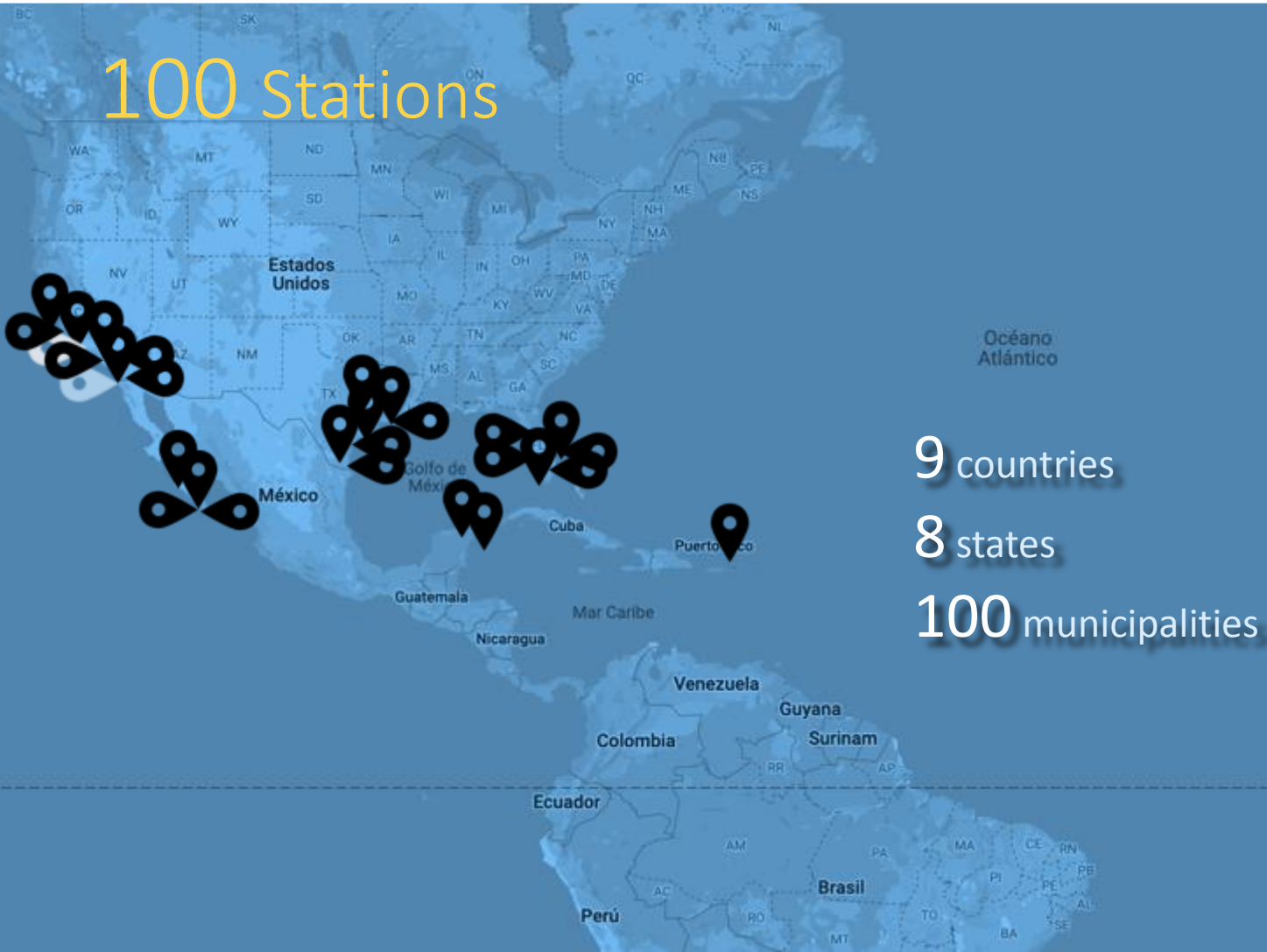



# Market

## SkyH2O Positioning

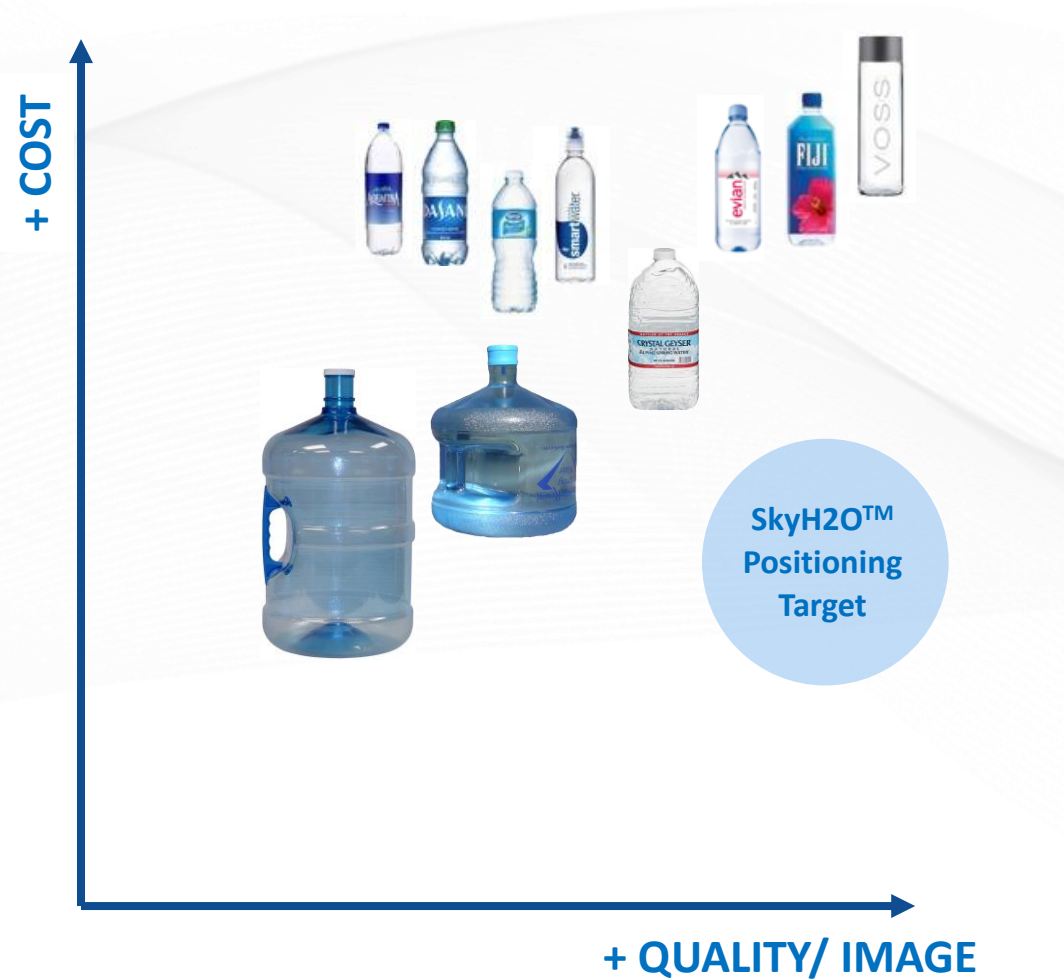

## Global Water Market Size by Product

(USD Billion)

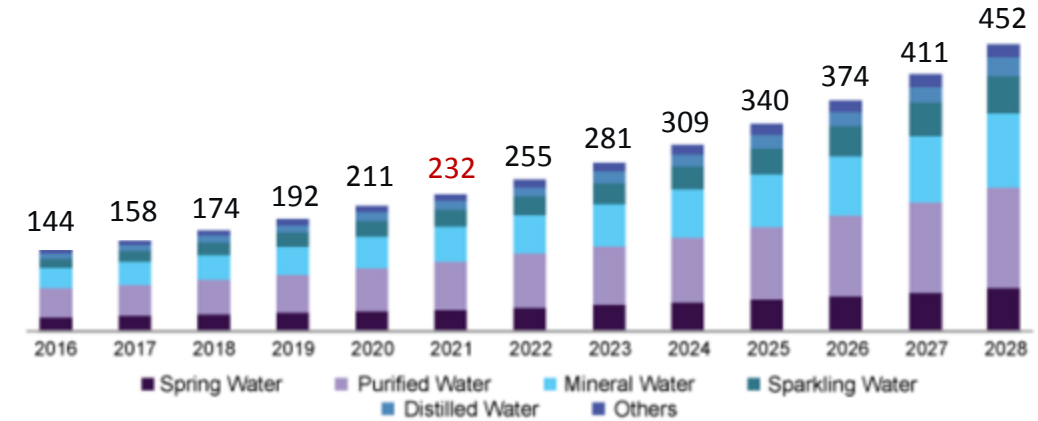

CAGR  
11.1%

Source: www.grandviewresearch.com

## Global Bottled Water Market (2020)

### Share by Product

- Spring Water
- Purified Water
- Mineral Water
- Sparkling Water
- Distilled Water
- Others



### Premium Market

### Share by Distribution Channel

- Supermarkets & Hypermarkets
- Speciality Stores
- Online
- Others



Global Premium Market Size (2020)

\$17.3B



### PROJECT FINANCING (USD)

<b>TOTAL COST</b>	\$15,000,000
	Including est. USD \$4.0M including USD 1.3M0 for +4 acres of land, and about 15,000 SF Class B industrial/retail facility
	Electrical requirements, industrial power, 3 phase , peek 3,000 kW
<b>USE OF PROCEEDS</b>	<ul style="list-style-type: none"> <li>I. Pre-Construction, 6-months                             <ul style="list-style-type: none"> <li>i. \$400,000 for soft costs, design and permitting</li> </ul> </li> <li>II. EPC Construction, 12-months                             <ul style="list-style-type: none"> <li>i. \$4,800,000 for 12 AWS MAXIMUS systems</li> <li>ii. \$1,200,000 for storage, collection and piping</li> <li>iii. \$ 400,000 for water Preparation and Mineralization equipment</li> <li>iv. \$1,000,000 for bottling system including filling, capping and cleaning, and blow mold bottle maker</li> <li>v. \$300,000 for water transportation trucks</li> <li>vi. \$500,000 for EV charging</li> <li>vii. \$500,000 for Inventory, miscellaneous , and contingency</li> <li>viii. \$1,500,000 for EPC Construction services</li> </ul> </li> </ul>

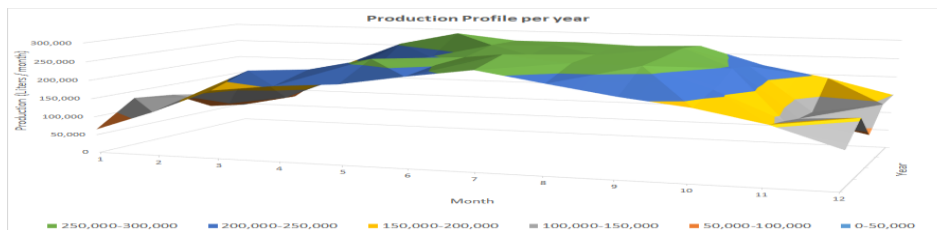

### OPERATIONS BUDGET (USD)

<b>SIZE ANNUAL WATER GENERATION (GALLONS)</b>	\$11,000,000
<b>REVENUE PER YEAR</b>	<b>EBITDA PER YEAR</b>
@ \$0.80/GAL	i. \$8,800,000      \$2,065,000
@ \$1.00/GAL	ii. <b>\$11,000,000</b> <b>\$4,265,000</b>
@ \$1.20/GAL	iii. \$13,200,000      \$6,465,000
<b>Assumption Water Sales</b>	50% Bottled Water, 50% Bulk Water both raw/purified & potable
<b>COST OF GOODS SOLD PER YEAR</b>	i. \$1,735,000
<b>*50% sales with-out bottles</b>	<ul style="list-style-type: none"> <li>i. LCOW Generation US Cents 8.0/GAL</li> <li>ii. Water preparation/mineralization US Cents 1.5/GAL</li> <li>iii. Bottling, filling, capping (1, 3 and 5 GAL bottles) US Cents 12.5/GAL</li> </ul>
<b>OPERATING COSTS PER YEAR</b>	ii. \$5,000,000
	<ul style="list-style-type: none"> <li>i. \$1,200,000 for Salaries and wages for 12 to 18 employees</li> <li>ii. \$500,000 for leasing of land and building “lease back”</li> <li>iii. \$2,400.000 Sales and Marketing</li> <li>iv. \$900,000 Miscellaneous</li> </ul>
<b>NOTE: LCOW = CapEx + OpEx + EnergyEx.</b>	
<b>Energy cost is est at Cents 7/kWh</b>	



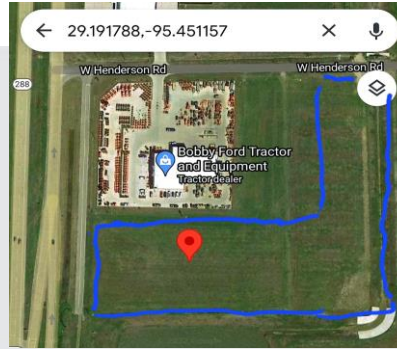

WHERE SUSTAINABILITY AND PROFITABILITY MEET

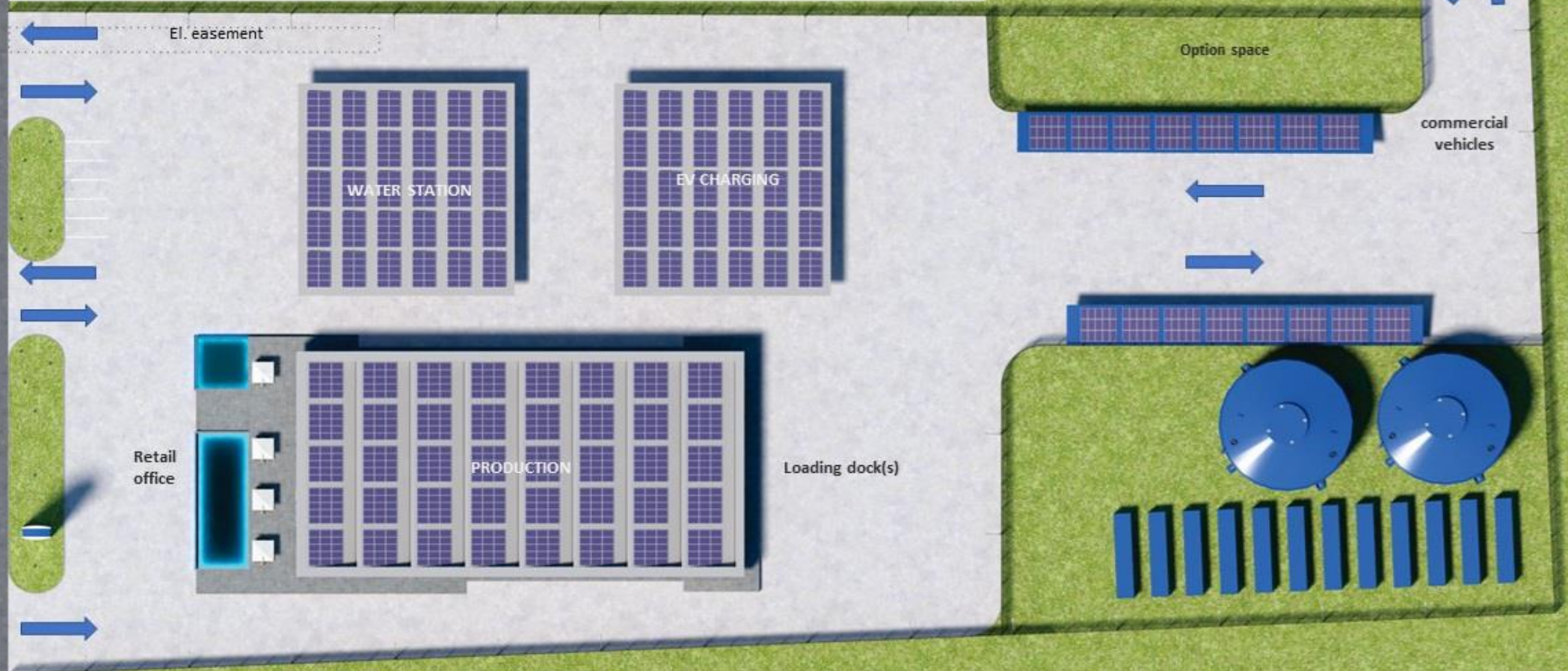



# An Impactful OPPORTUNITY:

	Americas	Global
Total Addressable Market:	+200 stations	+1,000 stations
Primary Locations:	Texas, California, Florida, further Southeast USA and Mexico	EU Mediterranean (Spain, Italy, others) MENA (Saudi Arabia, Morocco, others) and Islands including Caribbean
Investment Value:	\$3.0B	\$15.2B
Annual Revenue (cumulative):	\$2.2B	\$11.2B
Annual Profits (cumulative):	\$600.0M	\$3.0B

In Sum: *“At SkyH2O we are creating an additional distribution channel for premium water while driving our own growth”.*



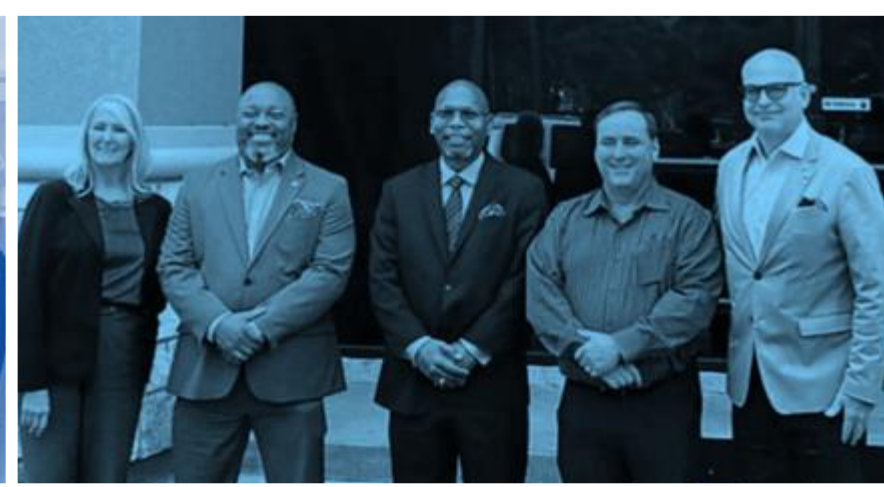

*“We want to thank state and municipal authorities in Texas and Baja California Sur for their support and assistance in making SkyH2O a pioneer in renewable water solutions”.*

Alexander von Welcke  
Founder & CEO  
SkyH2O





# SkyH2O STATION™ Leadership Team

SkyH2O's international team is formed by a seasoned group of professionals experienced in the fields of water and energy, development, real estate, financing and project management, and corporate development.



Alexander  
von WELCZECK  
President & CEO



Charlie  
KUFFNER, P.E.  
Chief Operations



James  
POOLE, P.E.  
Chief Engineering



Richard  
GUERRA  
Director, Project  
Management



Dr. Walter  
SCHINDLER, JD  
Chairman,  
International Advisory Board



David  
NOYES, CPA MBA  
Chief Financial



Lawrence  
SIMPELO  
Director, Marketing  
& Communications



Lollie  
ADDLEMAN  
Director, Retail  
Operations



Guillermo  
SEPULVEDA, MBA  
Director, Mexico  
& Latin America



Kristina  
PETERSON, MBA  
Advisor, Financing  
International  
Advisory Board



Dirk  
MICHELS, JD.  
Legal Counsel



Terell  
JONES  
Director, Business  
Development &  
Alliances



Joseph  
STEIN, Dipl.-ING  
Advisor,  
Architect & Design

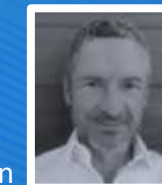

Wolfgang  
STRASSER, Ph.D.  
Director, Europe  
("EU")



Thomas  
SCHUMANN  
Advisor, Water Security  
International Advisory Board





## FORMATS:

---

- **AGENTS:** We offer an “Ambassadorship” to well qualified professionals that want to promote SkyH2O’s products and water stations.
- **JV PARTNERS:** We seek strategic joint ventures with local investors in target markets to co-develop markets and projects
- **IMPACT INVESTORS:** We welcome impact investors that want to participate in the rewards of fueling growth.

## INVESTMENT OPPORTUNITIES:

---

- **EQUITY:** Investments of up to **USD \$50M** in **SkyH2O Inc.** , common shares (Min. \$250k)
- **DEBT:** Financing up to **\$25M** to manufacture finished goods inventory.
- **PROJECT FINANCING:** Up to **\$150M to** fund Phase I Water Stations program (10) @ USD \$15M avg. each
- **STRATEGIC INVESTMENTS:** Of up to **\$10M** in each of **SkyH2O MENA Ltd.** (Abu Dhabi, UAE) and **SkyH2O Asia Ltd.** (Hong Kong, China)



## Contacts

**ALEXANDER VON WELCZECK**

President & CEO

C. +1 415 794.3311

alex@skyh2o.com

### USA

**TERELL JONES**

C. +1 210 867-1100

terell@skyh2o.com

### Mexico & LatAm

**GUILLERMO J. SEPÚLVEDA**

C. +52 55 4088.4166

guillermo@skyh2o.com

### European Union

**WOLFGANG STRASSER**

C. +34 62 712 4041

wolfgang@skyh2o.com

#### Disclaimer

This presentation was prepared exclusively for the benefit and internal use of the recipient in order to indicate, on a preliminary basis, the feasibility of a possible transaction or transactions and does not carry any right of publication or disclosure to any other party without the prior written consent of SkyH2O Inc. This document herewith does not purport to be complete or contain all of the information which a prospective investor may require. No representation or warranty is made as to the accuracy, reliability or completeness of any information contained in this document. They do not constitute, and should not be regarded as, a representation that the projected results will actually be achieved or that the underlying assumptions are valid. The information in this presentation does not take into account the effects of a possible transaction or transactions involving an actual or potential change of control, which may have significant valuation and other effects.